

AQUA ENERGY DL HIGH PRESSURE

AQUA ENERGY INTERNATIONAL LTD

28 St James Business Centre

Linwood Road

Paisley PA3 3AT

Scotland, UK

Tel: (+44) (0) 141 849 6888

Fax: (+44) (0) 141 848 5777

E-mail: sales@aquaenergy.com

www.aquaenergy.com

INDUSTRIAL PLUNGER PUMP



PUMP SPECIFICATIONS

Rated Horsepower -----190

Number of cylinders -----3

Plunger Stroke -----mm72

Oil Capacity ----- Lt 14

Pump Weight -----Kg 392

FLUID END

FLUID HEAD - Chemical nickel treated spheroidal cast iron.

VALVES & SEATS – Vertical fitted valves made in stainless steel and Bronze.

PLUNGERS - Stainless Steel with ceramic coating.

PACKING – Double Pressure Packing giving long service.

LUBRICATION - Plungers and Packing lubricated by water supply with water spill venting.

POWER END

POWER FRAME - High strength cast iron.

CRANKSHAFT - Hardened and tempered alloy steel.

CRANKSHAFT BEARINGS - Double roller rim.

CONNECTING RODS - Surface treated spheroidal cast iron.

REDUCTION GEAR - External 3.29:1 or 2.65: 1 reduction ratio gear from either side of pump.

LUBRICATION – Power end parts and gearbox are splash lubricated by oil in crankshaft reservoir.

DL SERIES TRIPLEX

1500 rpm /1 (ratio 1:2,65) *

| Model | Flow rate | | Pressure | | | G/min r.p.m. | Power | |
|-------|-----------|--------|----------|-----|------|-----------------|-------|-----|
| | l/min | US Gpm | Bar | MPa | Psi | | Kw | Hp |
| DL 40 | 182 | 48.2 | 400 | 40 | 5800 | 1500/1800 | 140.5 | 191 |
| DL 45 | 231 | 61.0 | 300 | 30 | 4350 | 1500/1800 | 134 | 182 |
| DL 50 | 285 | 75.3 | 250 | 25 | 3600 | 1500/1800 | 137.5 | 187 |
| DL 55 | 345 | 91.1 | 200 | 20 | 2900 | 1500/1800 | 132 | 180 |
| DL 60 | 410 | 108.4 | 170 | 17 | 2500 | 1500/1800 | 135 | 183 |
| DL 65 | 481 | 127.0 | 150 | 15 | 2180 | 1500/1800 | 140 | 190 |

Performance refers to theoretical delivery with 100% volumetric efficiency.

Under normal operating conditions, pump volumetric efficiency is over 95%.

Please contact our technical staff in case continuous and heavy-duty, or special applications.

CONSTRUCTION

- High pressure plunger pump, available in 3 versions.
- Low-high pressure packing design with integrated cooling system.
- High volumetric efficiency suction/delivery valves featuring new spherical design of sealing areas.
- Splash lubrication.
- External gear box available in two ratios and positionable on left or right side of the pump at 0°-45°-90°-135°-180° from the horizontal axis (see drawing).
- Drain valve kits

MATERIAL QUALITY

- Pump body in cast iron.
- Manifold made of spheroidal cast iron, nickel treated.
- Self adjusting shaft bearings with double roller rim.
- Forged steel connecting rods with antifriction bearings
- Cranksahft made of nitrited, hardened and tempered alloy steel
- Cast iron piston guide, nickel treated.
- Solid ceramic plungers.
- Stainless steel valves.

DLS PUMP:

Maximum design pressure 400bar (5,800psi)

Maximum inlet pressure 3 bar (45psi)

Standard connections: Suction ----- 80mm
Discharge ----- 1¼"

Table of pump versions

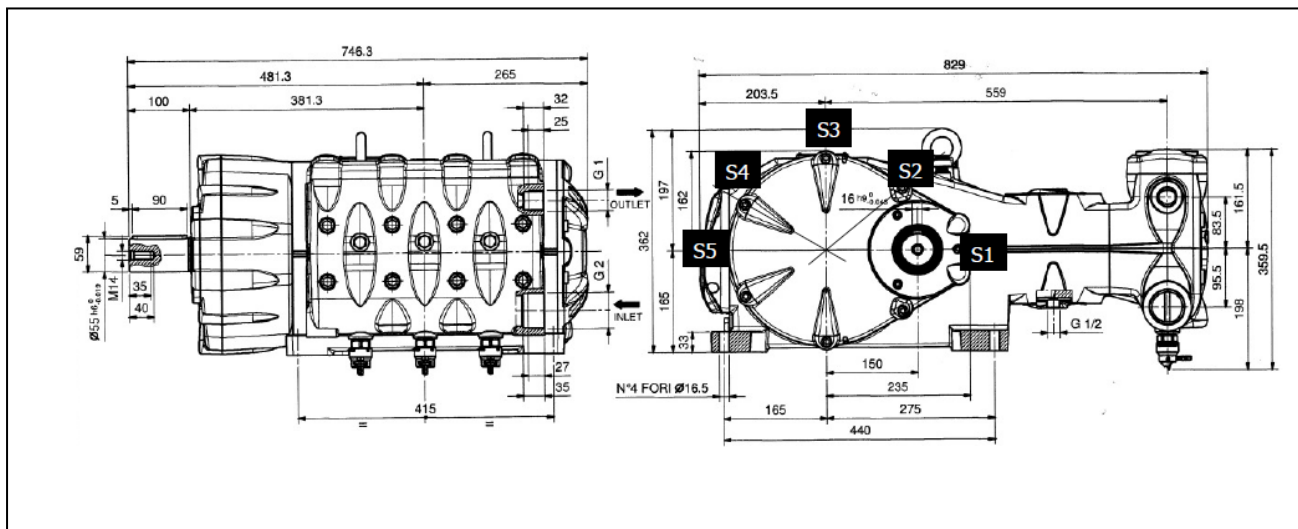
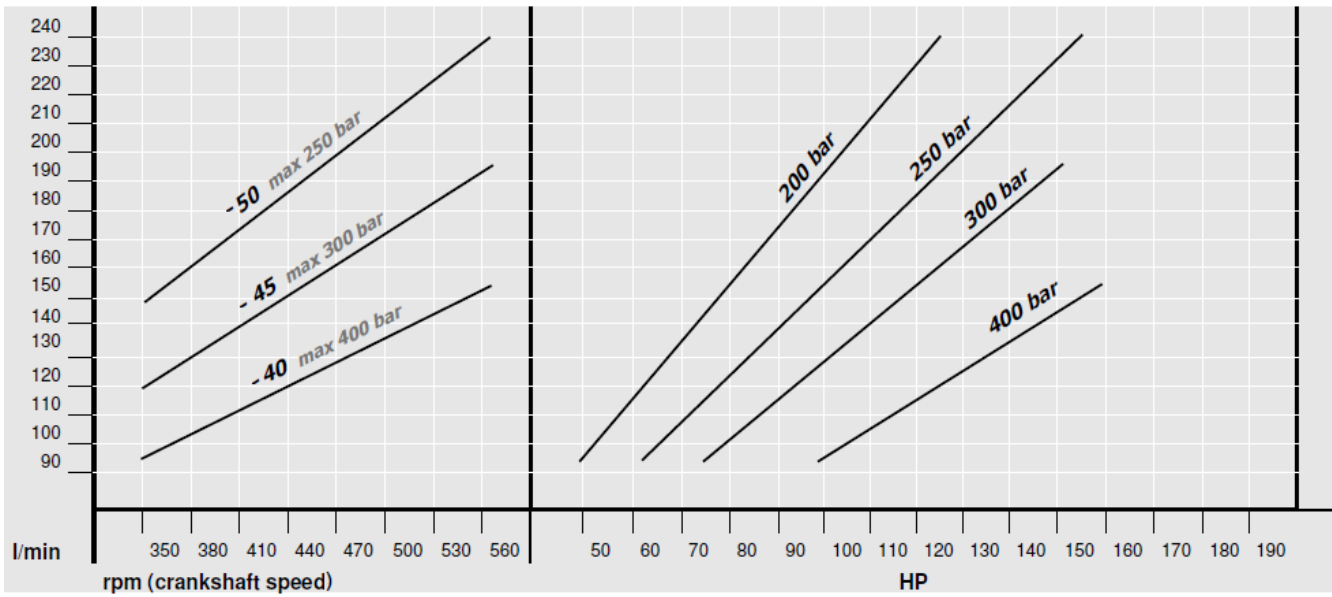

S Gear box on the left side

D Gear box on the right side

S1 Gear box is shown in position S1 (left side, 0° angle).

Connection kits :

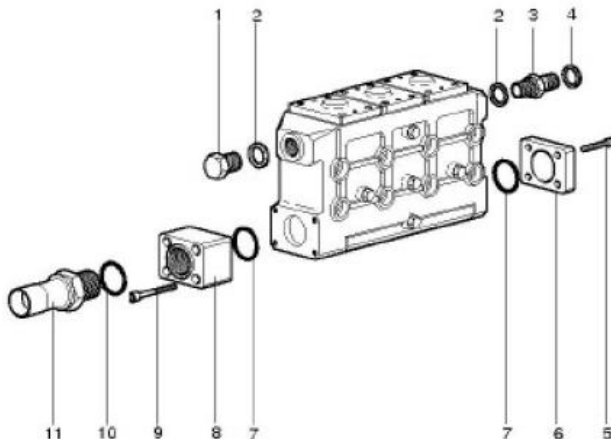

| POS. | VALVE CONNEX. | CODE | DESCRIPTION | KIT | N. PCS. |
|------|---------------|-------------|------------------------------|-------|---------|
| 1 | | 8212.0105.7 | Cap G 1" 1/4 | A | 1 |
| 2 | | 8811.1010.4 | Sealing washer Ø 1" 1/4 | A-B-C | 1 |
| 3 | PN3 | 8210.2001.7 | Nipple G 1" 1/4 - 1" 1/2 | B | 1 |
| | RV3 | 8210.2002.2 | Nipple G 1" 1/4 | C | 1 |
| 4 | PN3 | 8811.1010.5 | Sealing washer Ø 1" 1/2 | B | 1 |
| | RV3 | 8811.1010.4 | Sealing washer Ø 1" 1/4 | C | 1 |
| 5 | | 8711.2515.4 | Screw TCEI M10X30 | D | 4 |
| 6 | | 0631.0001.0 | Flange suction | D | 1 |
| 7 | | 8810.1125.4 | OR Ø 85x4 | D-E | 1 |
| 8 | | 0731.0001.0 | Hose suction | E | 1 |
| 9 | | 8711.2516.0 | Screw TCEI M10X60 | E | 4 |
| 10 | | 8810.1117.1 | OR Ø 90x3 | F | 1 |
| 11 | | 0730.0001.0 | Straight hose connector Ø 90 | F | 1 |

| Fittings kit | | | |
|--------------|----------|----------|----------|
| A | KIT 1150 | D | KIT 1201 |
| B | KIT 1151 | E | KIT 1202 |
| C | KIT 1152 | F | KIT 1203 |