

# AQUA ENERGY

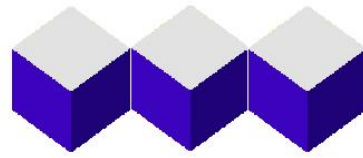

"WATERJET SOLUTIONS"

## Hand-Held Zero Thrust Control Gun

Pressures from 690 – 1034 bar (10,000 – 15,000 psi)

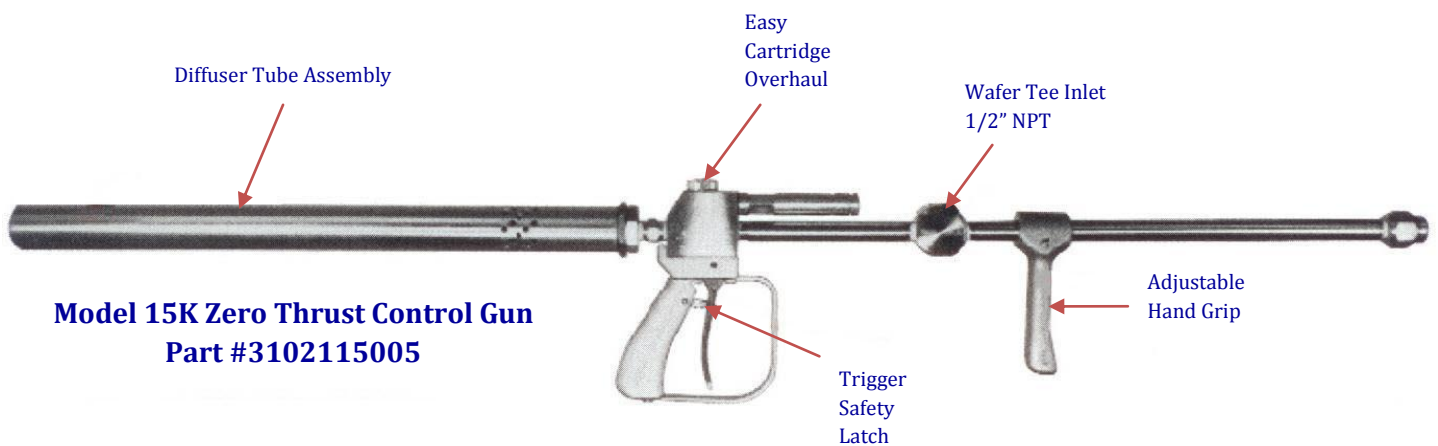

Designed for underwater or topside use where balance is critical.  
The equal forward and backward thrust allows the operator to be in balance.

Constructed of stainless steel for corrosion resistance.

Vertical inlet connection for underwater use.

Adjustable hand grip.

Features 60 second cartridge overhaul.

**Weighs only 7.26 Kgs (16 lbs)**

### 60 Second Cartridge Overhaul

Remove Cartridge Adapter

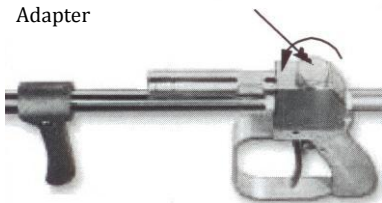

STEP 1

Align lobe on cartridge assembly with groove in cartridge adapter and turn counter clockwise to unlock and remove



STEP 2

Replace cartridge and install in block

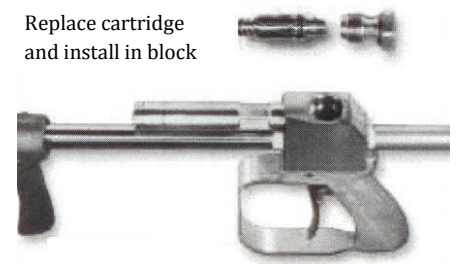

STEP 3

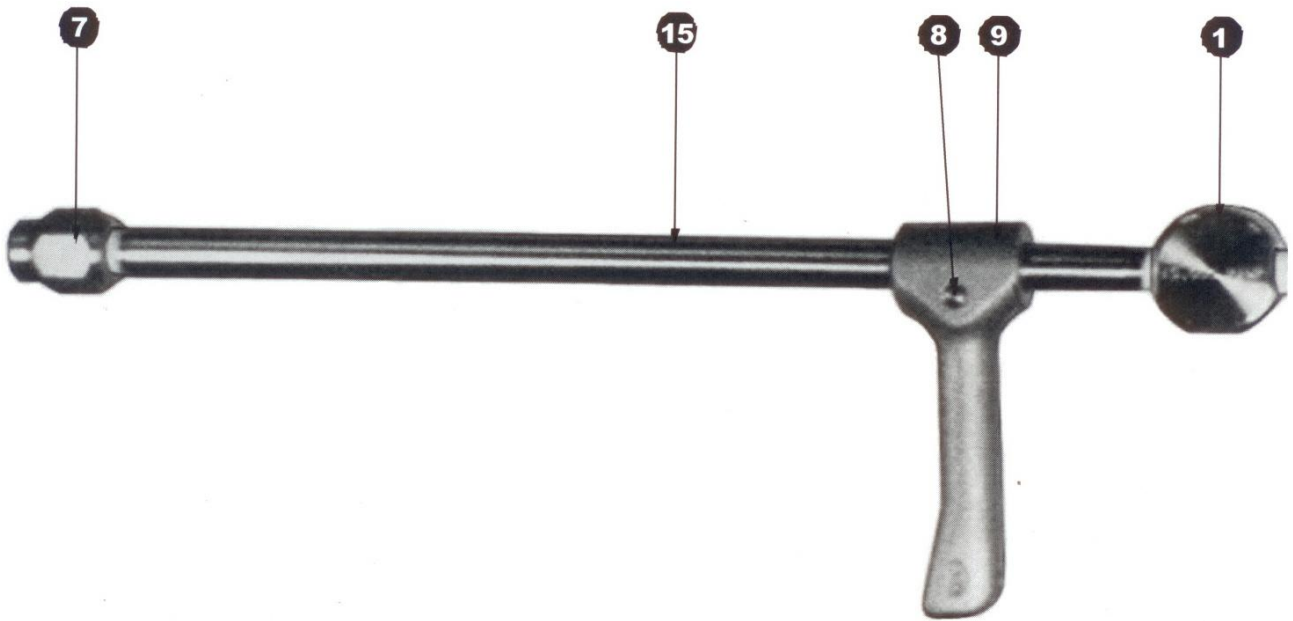

ITEM	DESCRIPTION	QUANTITY	PART NO
<b>COMPLETE</b>	<b>HG Series Hand Held Zero Thrust Control Gun</b>	<b>1</b>	<b>3102115005</b>
1	Wafer Tee 1/2" NPTF, Inlet	1	77131003
2	Hex Nipple, 1/2" MNPT	1	77208005
3	Cap Screw, 1/4"-20 x 3/4" Long	1	77408020
4	Screw, 1/4"-20 x 1" SHCS SS	2	77700610
5	Screw, 1/4"-20 x 1/2" SHCS	2	77513017
6	Safecheck Valve O-Ring, 15/20K	1	2220016
7	Nozzle Holder, 1/2" FNPT x 1/4"	2	77513028
8	Cam Stud Assembly, 1/2" Pipe	1	77513031
9	Hand Grip Frame, 1/2" Pipe	1	77513033
10	Valve Cartridge Assembly, 10/15K	1	3102111
11	Safety Latch, HG/HGLT	1	77700025
12	Safety Latch Pin	1	77700027
13	Trigger Pivot Pin	1	77700045
14	Zero Thrust Diffuser	1	77700058
15	Nipple, 1/2" NPT x 36" SS, 15K	1	77700072
16	Nipple, 1/2" NPT x 6" SS, 15K	1	77700092

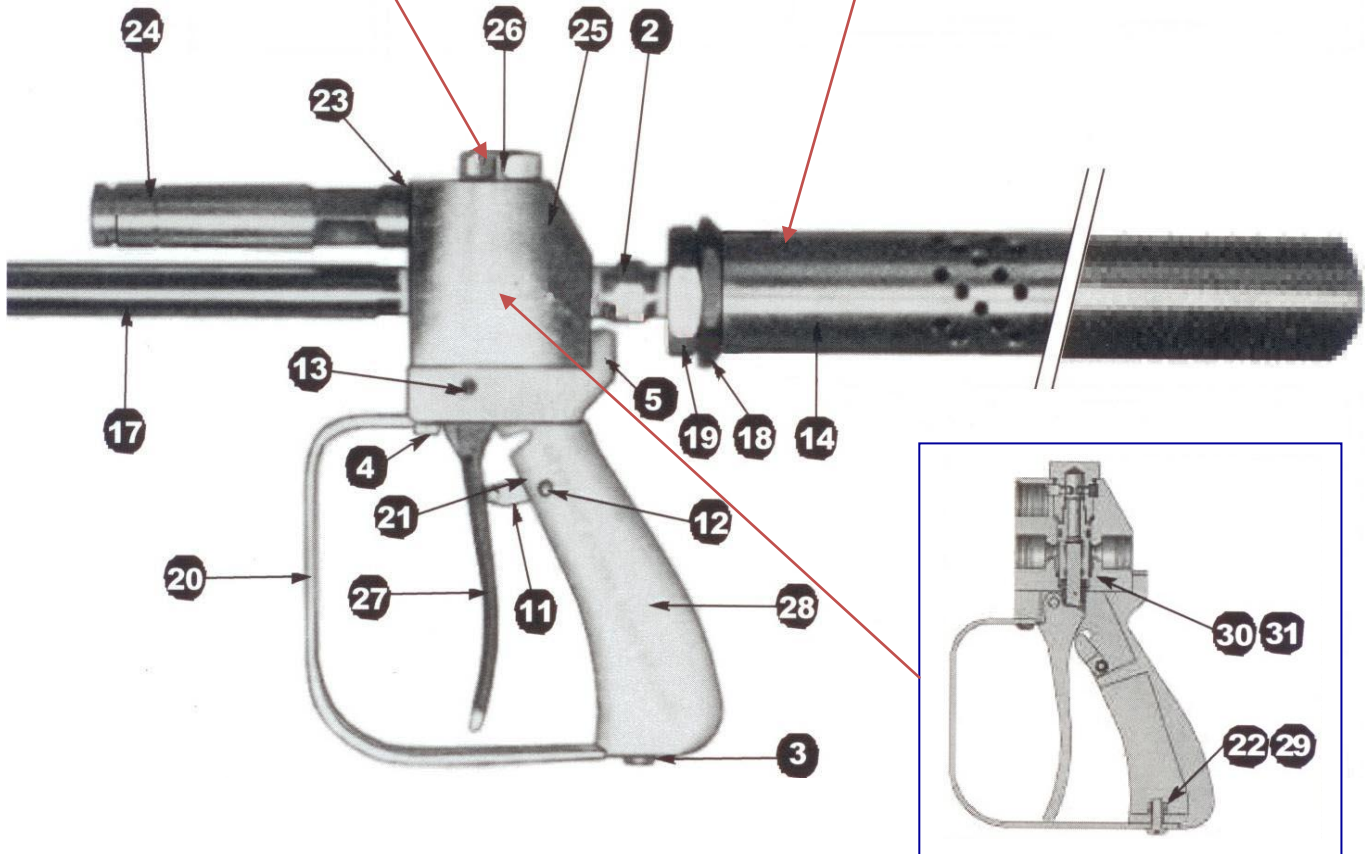
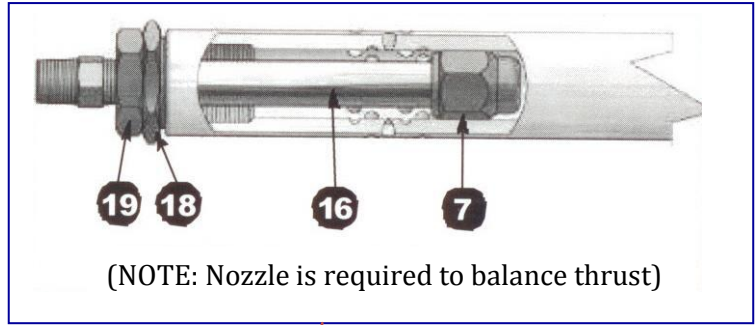

ITEM	DESCRIPTION	QUANTITY	PART NO
17	Nipple, 1/2" NPT x 12" SS, 15K	1	77700093
18	Jam Nut, 1 3/4"-12	1	77700157
19	Zero Thrust Diffuser Adapter	1	77700158
20	Trigger Guard, 15/20K	1	77700513
21	Safety Latch Spring	1	77700517
22	Nut, 1/4" Square	1	77700528
23	O-Ring Valve Seat - 017	1	77700539
24	Ultra Safe Dump Tube	1	77700613
25	Ultra Safe 15K Dump Gun Block	1	77700615
26	Dump Adaptor for 15K Dump Gun	1	77700616
27	Trigger for 15K Dump Gun	1	77700617
28	Handle, 20K Dump Gun	1	77700625
29	Lock Washer, 1/4" SS	1	77408150-3
30	Valve Seat O-Ring, 7/8"	1	2217046
31	Valve Seat Back-Up Ring, 7/8"	1	2217047

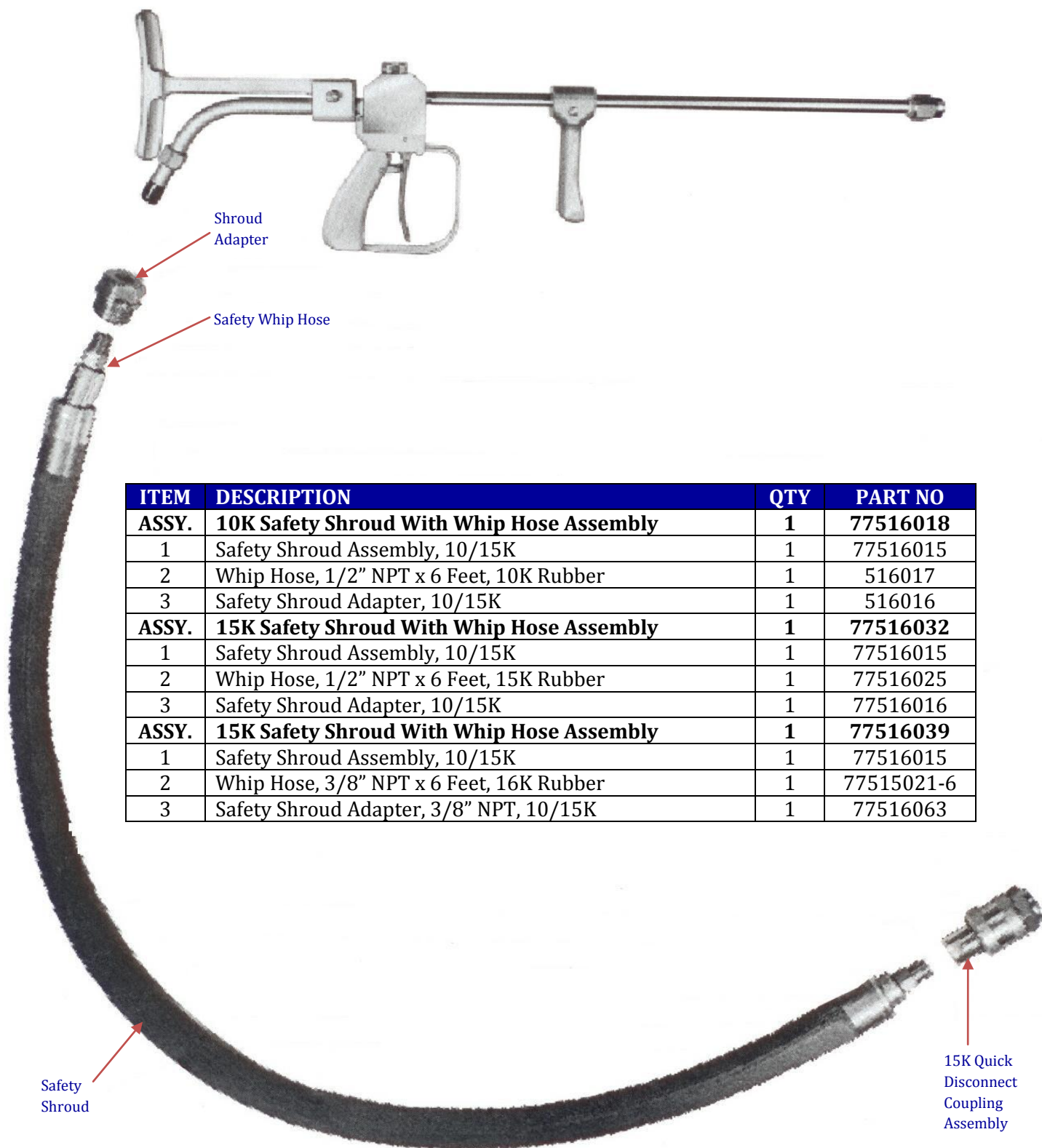

ITEM	DESCRIPTION	QTY	PART NO
<b>ASSY.</b>	<b>10K Safety Shroud With Whip Hose Assembly</b>	<b>1</b>	<b>77516018</b>
1	Safety Shroud Assembly, 10/15K	1	77516015
2	Whip Hose, 1/2" NPT x 6 Feet, 10K Rubber	1	516017
3	Safety Shroud Adapter, 10/15K	1	516016
<b>ASSY.</b>	<b>15K Safety Shroud With Whip Hose Assembly</b>	<b>1</b>	<b>77516032</b>
1	Safety Shroud Assembly, 10/15K	1	77516015
2	Whip Hose, 1/2" NPT x 6 Feet, 15K Rubber	1	77516025
3	Safety Shroud Adapter, 10/15K	1	77516016
<b>ASSY.</b>	<b>15K Safety Shroud With Whip Hose Assembly</b>	<b>1</b>	<b>77516039</b>
1	Safety Shroud Assembly, 10/15K	1	77516015
2	Whip Hose, 3/8" NPT x 6 Feet, 16K Rubber	1	77515021-6
3	Safety Shroud Adapter, 3/8" NPT, 10/15K	1	77516063

**Applications/Features:**

Operator safety is the first consideration when water blasting, the **Aqua Energy 10/15K Safety Shroud** is designed specifically for use with hand held control guns. These safety shrouds protect the operator from dangerous hose failures occurring near the gun. One should NEVER connect an un-shrouded hose directly to a water blasting gun. ALWAYS connect a whip hose and safety shroud to the gun first then connect the appropriate hose to the other end of the shroud/whip hose with a quick coupling. The **Aqua Energy 10/15K Safety Shroud** features a nitrile outer cover which is water, oil and soil resistant. The inner material consists of high strength braided stainless steel.

**AQUA ENERGY INTERNATIONAL LTD**  
 28 St James Business Centre, Linwood Road,  
 Paisley, PA3 3AT, Scotland, U.K.  
 Tel +(44) 141 849 6888  
 Fax +(44) 141 848 5777  
 sales@aquaenergy.com  
 www.aquaenergy.com